

- NOTE :
- 1: ALL WORKS TO BE CARRIED OUT IN STRICT ACCORDANCE WITH CURRENT BUILDING REGULATIONS, LATEST EDITION AND IN ACCORDANCE WITH SPECIFICATION.
 - 2: CONTRACTOR SHALL NOTIFY THE ARCHITECT OF ANY DISCREPANCIES ON THIS DRAWING BEFORE CARRING OUT ANY WORKS.
 - 3: ALL DIMENSIONS ARE TO FACE OF BLOCKWORK UNLESS NOTED OTHERWISE.
 - 4: AIRTIGHTNESS SEALING BY SPECIALIST CONTRACTOR; BUILDING CONTRACTOR TO LIAISE WITH SAME PRIOR TO CONSTRUCTION.
 - 5: CONTRACTOR TO THE LOCATION OF OVERHEAD POWER LINES ON THE SUBJECT SITE
 - 6: CONTRACTOR TO NOTED THERE IS A SUB SURFACE UNUSED GEOTHERMAL HEATING LOOP IN THE EXTENSION VICINITY WHICH WILL REQUIRE REMOVING

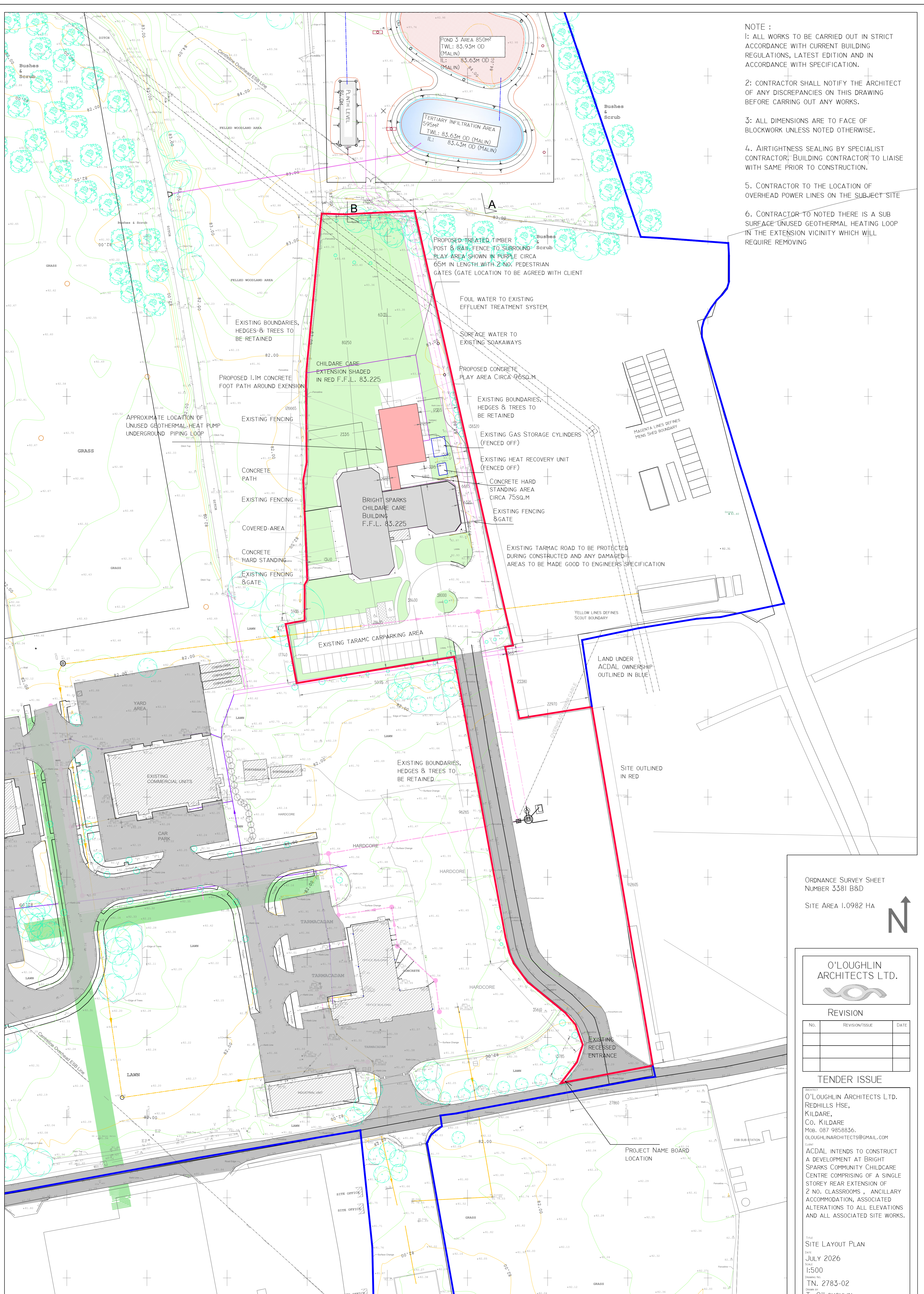

ORDNANCE SURVEY SHEET
NUMBER 3381 B&D

SITE AREA 1.0982 HA

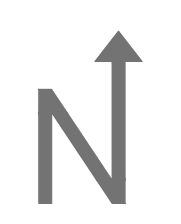

O'LOUGHLIN
ARCHITECTS LTD.

REVISION

NO.	REVISION/ISSUE	DATE

TENDER ISSUE

CLIENT
O'LOUGHLIN ARCHITECTS LTD.
REDHILLS HSE,
KILDARE,
CO. KILDARE
MOB. 087 9858836.
OLOUGHLINARCHITECTS@GMAIL.COM

PROJECT
ACDAL INTENDS TO CONSTRUCT A DEVELOPMENT AT BRIGHT SPARKS COMMUNITY CHILD CARE CENTRE COMPRISING OF A SINGLE STOREY REAR EXTENSION OF 2 NO. CLASSROOMS, ANCILLARY ACCOMMODATION, ASSOCIATED ALTERATIONS TO ALL ELEVATIONS AND ALL ASSOCIATED SITE WORKS.

TITLE
SITE LAYOUT PLAN

DATE
JULY 2026

SCALE
1:500

DRAWING NO.
TN. 2783-02

DRAWN BY
T. O'LOUGHLIN